

How to set the “Scene Switch” Key definition

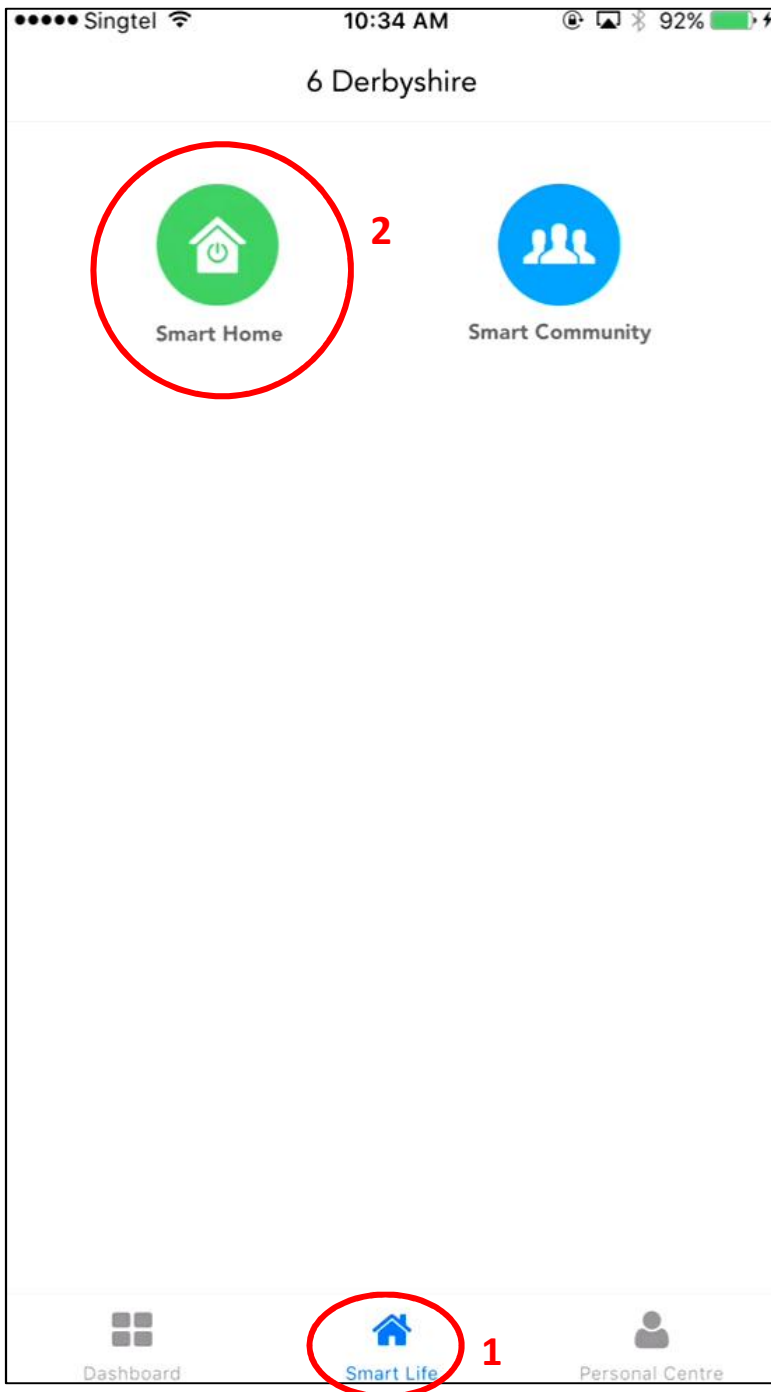

Turn to the "Smart Home"

1. Click "Smart Life"
2. Click "Smart Home"

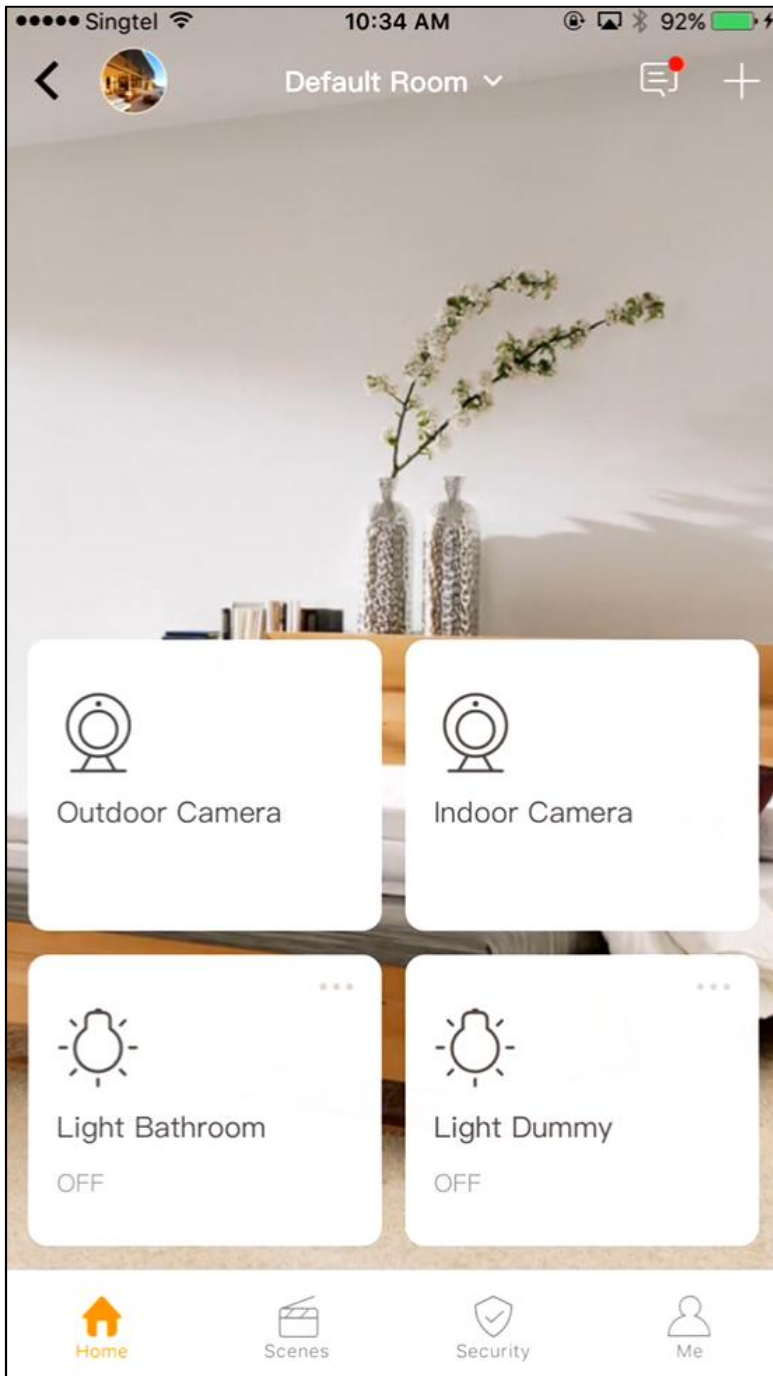

Stroll down to find “other devices”

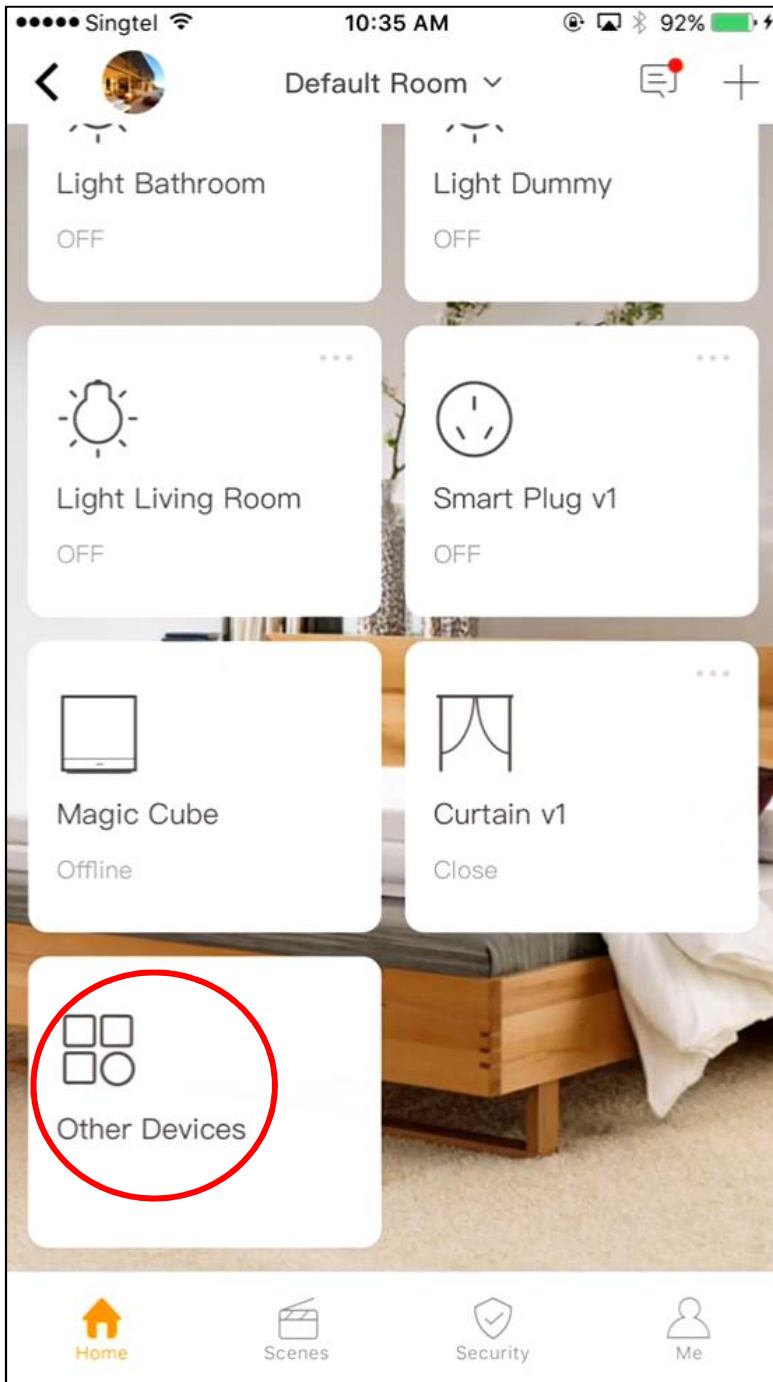

Click “Other Devices” to find out “Scene Panel”

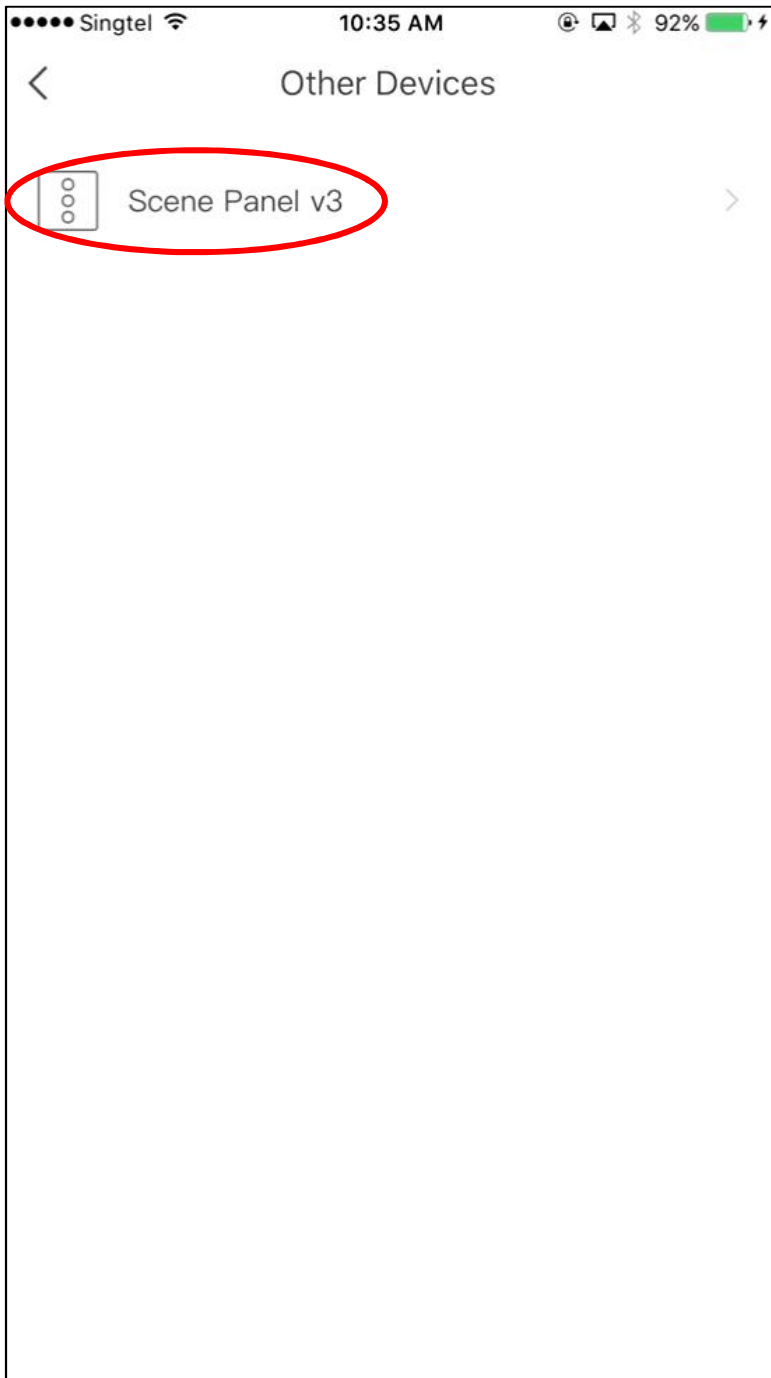

Click the "Scene Panel"

This Scene Panel is your Scene Switch

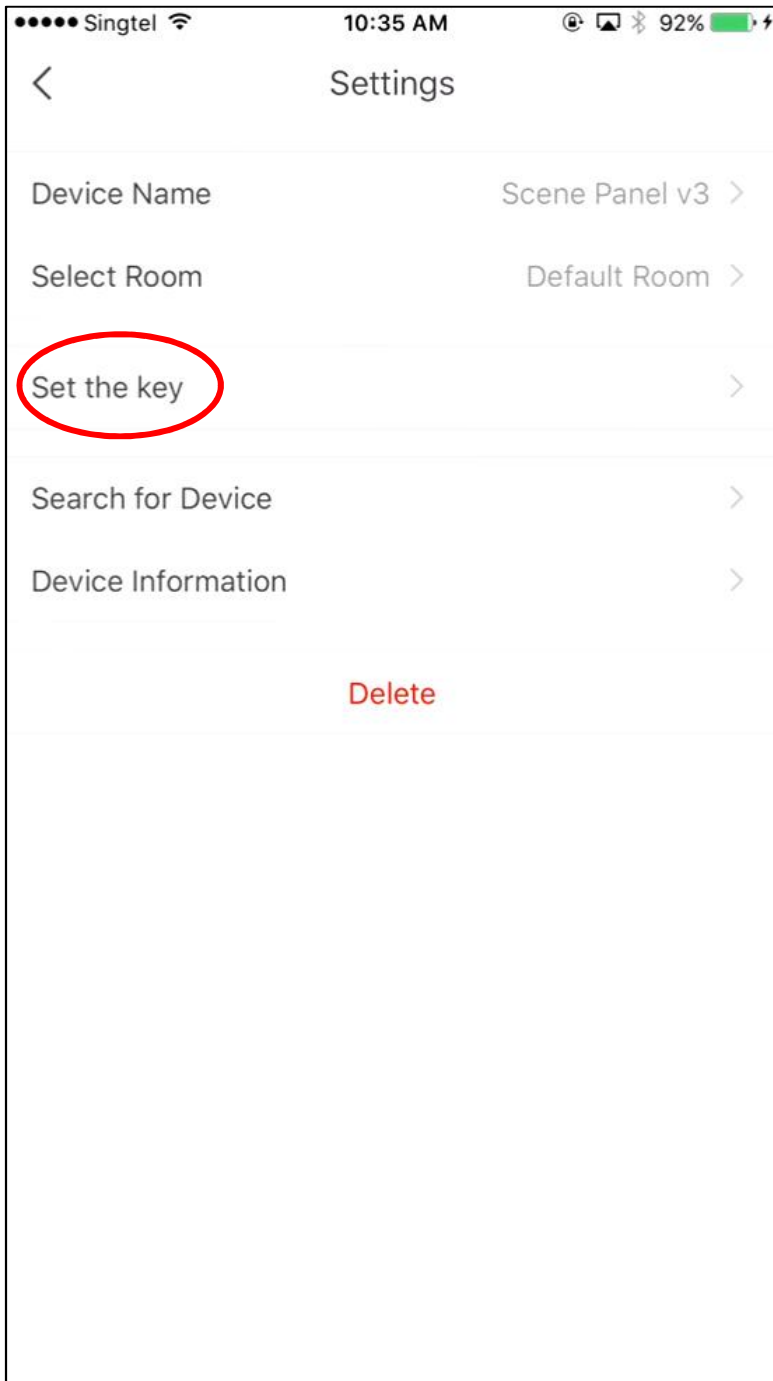

Click "Set the Key"

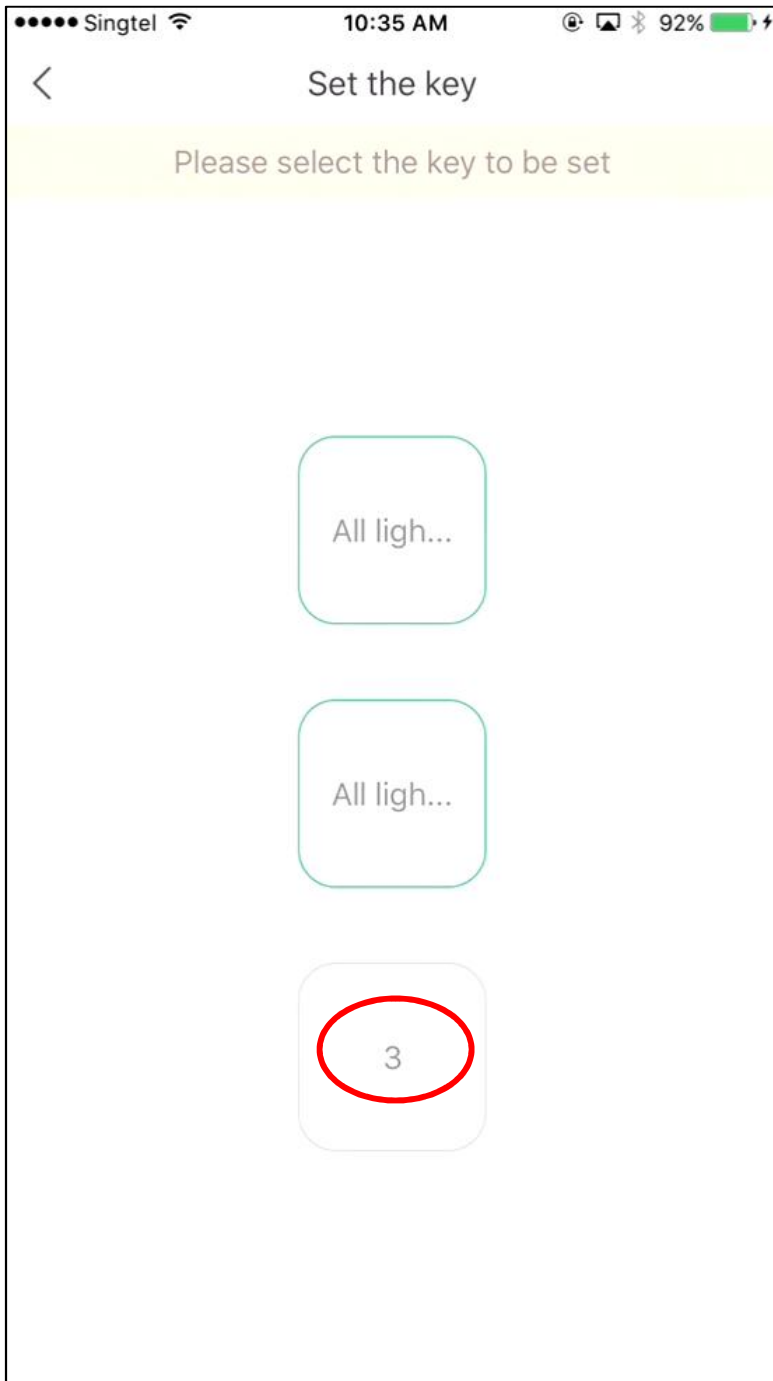

Select the key you would like to use.

For example: click the third button

* Same action if you would like modify the key definition later

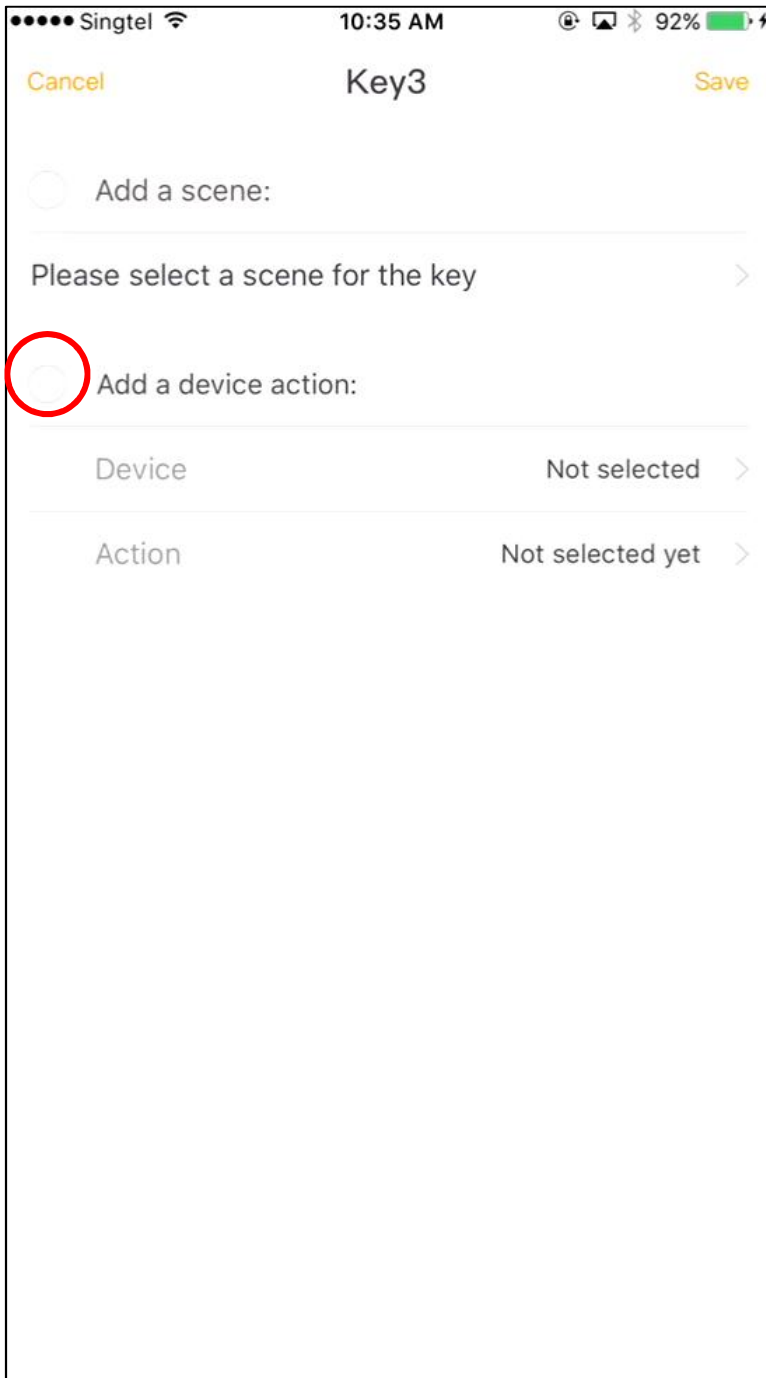

Tick the “Add Device Action”

Then the “Device” and “Action” can be set as below

If you would like control group of devices. Please tick the “Add a scene”, you have to set you scene mode before this action.

* Light is not support “ON/OFF” action in the scene mode.

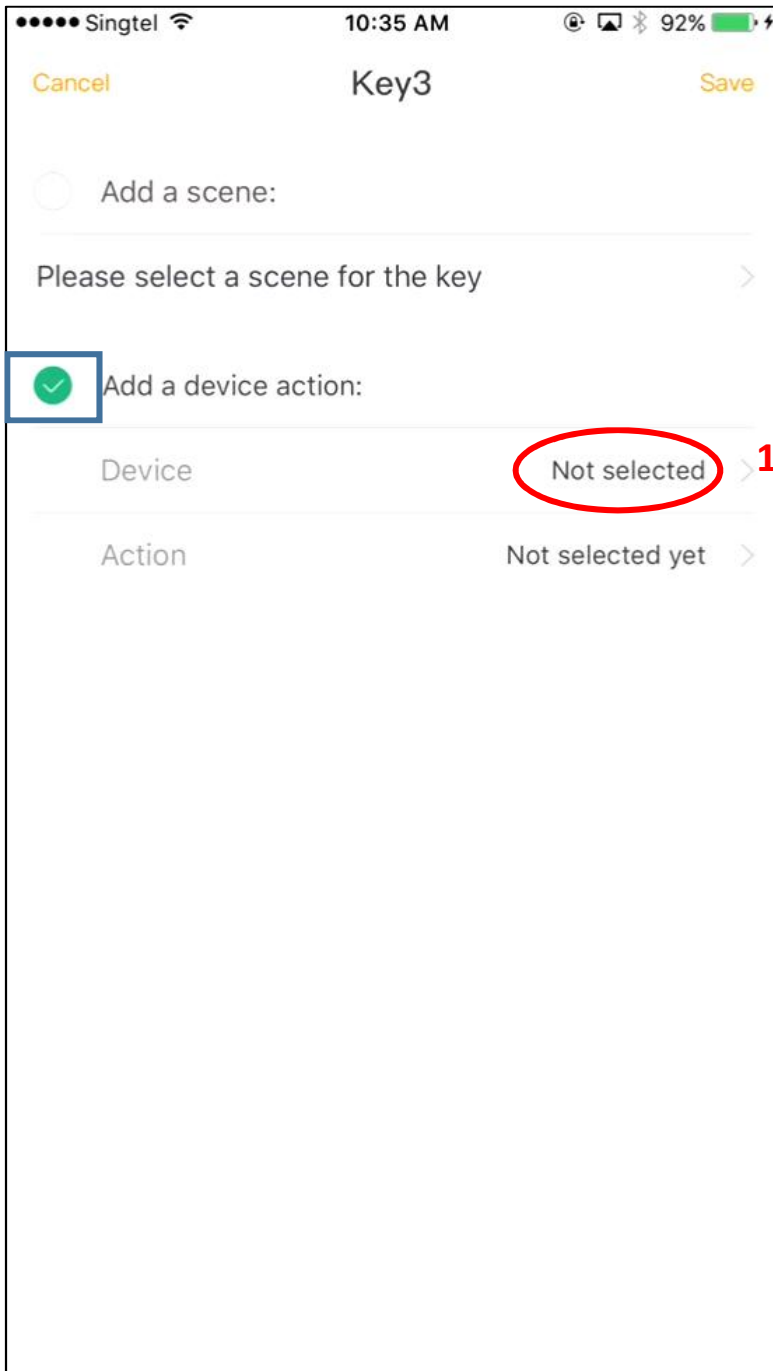

Make sure "Add device action" is ticked (Blue frame)

Step 1: Click "Device" to add new device

* Same setting action if you would modify to other device.

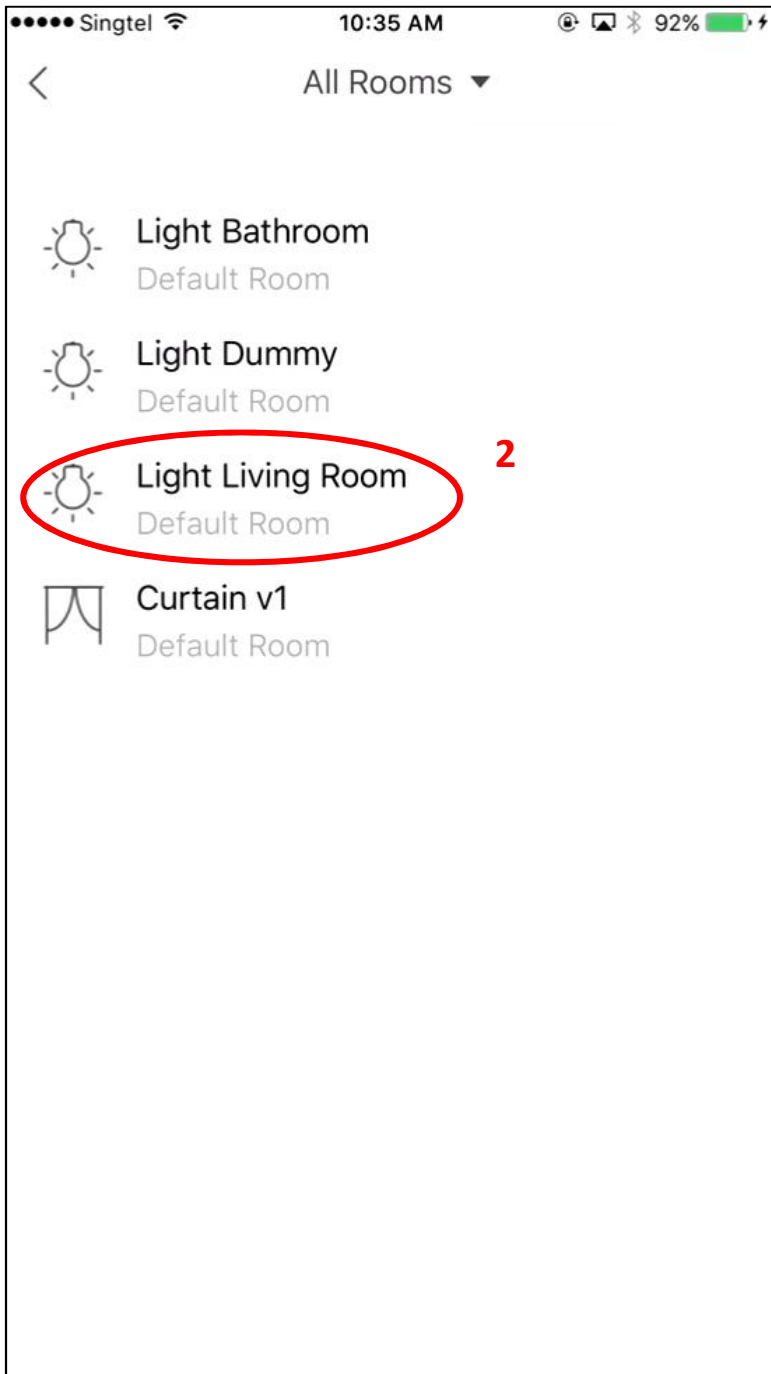

Step 2: Select the device you would like control

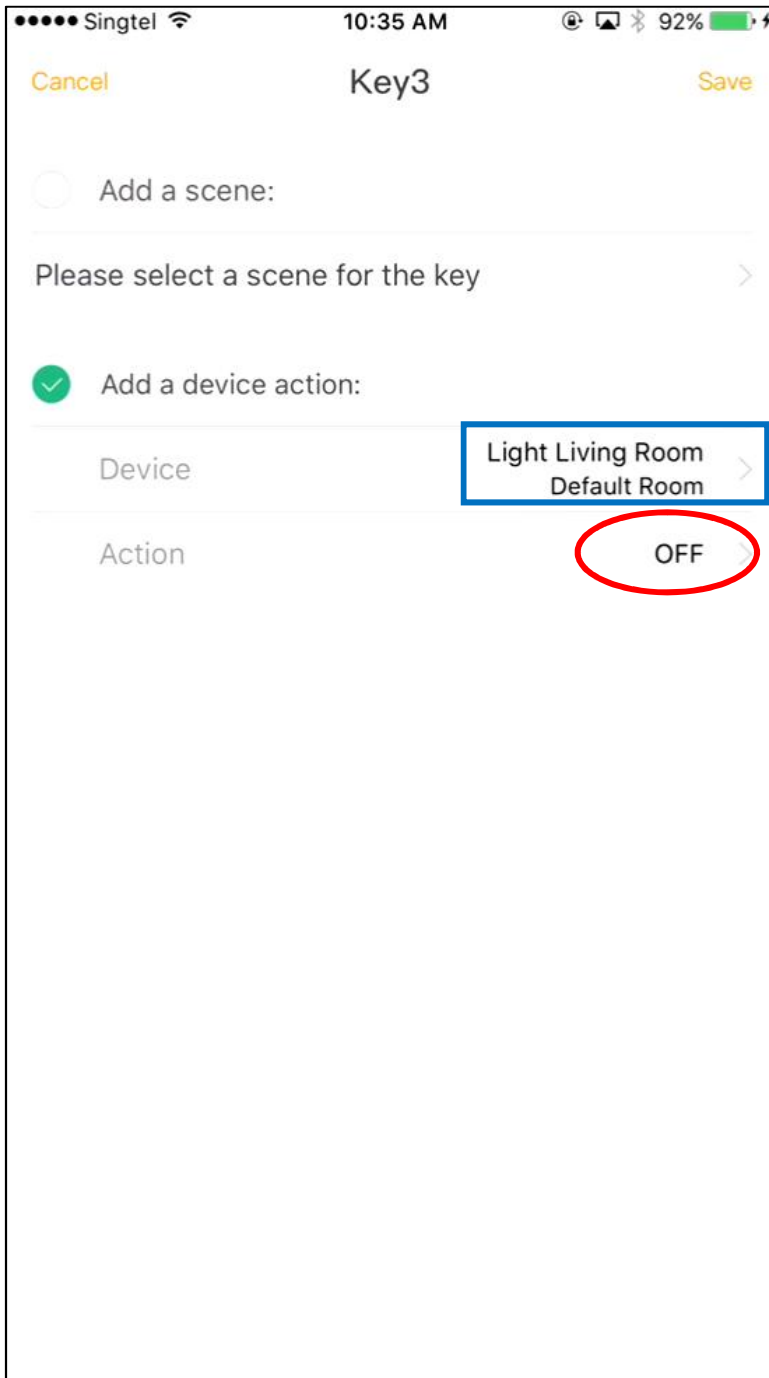

After add device, the device name will show up (Blue frame)

The action can be set like:

Step 1: Click "Action"

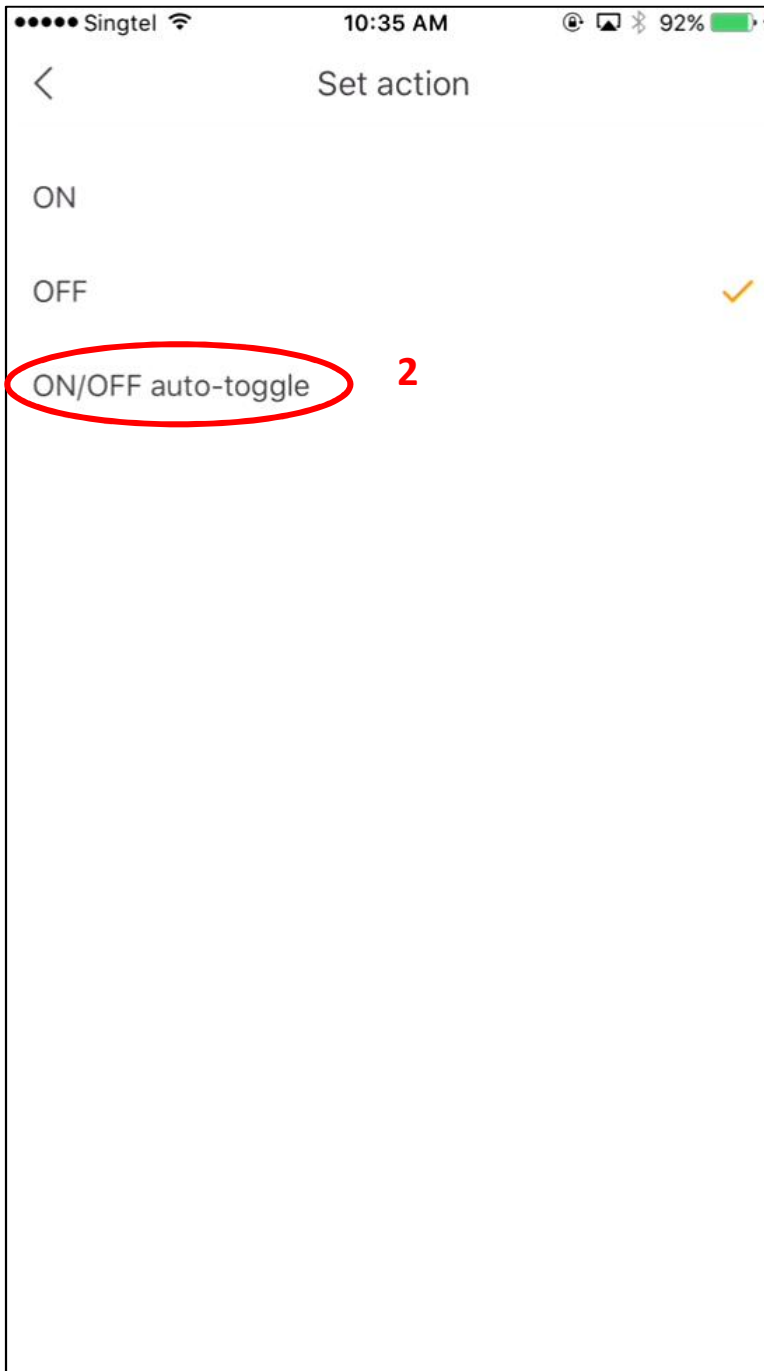

Step 2: Select "ON/OFF auto-toggle".

The scene switch 3rd button will control the light as one press light ON, second press light OFF

* Same action if you would like change to "ON" or "OFF"

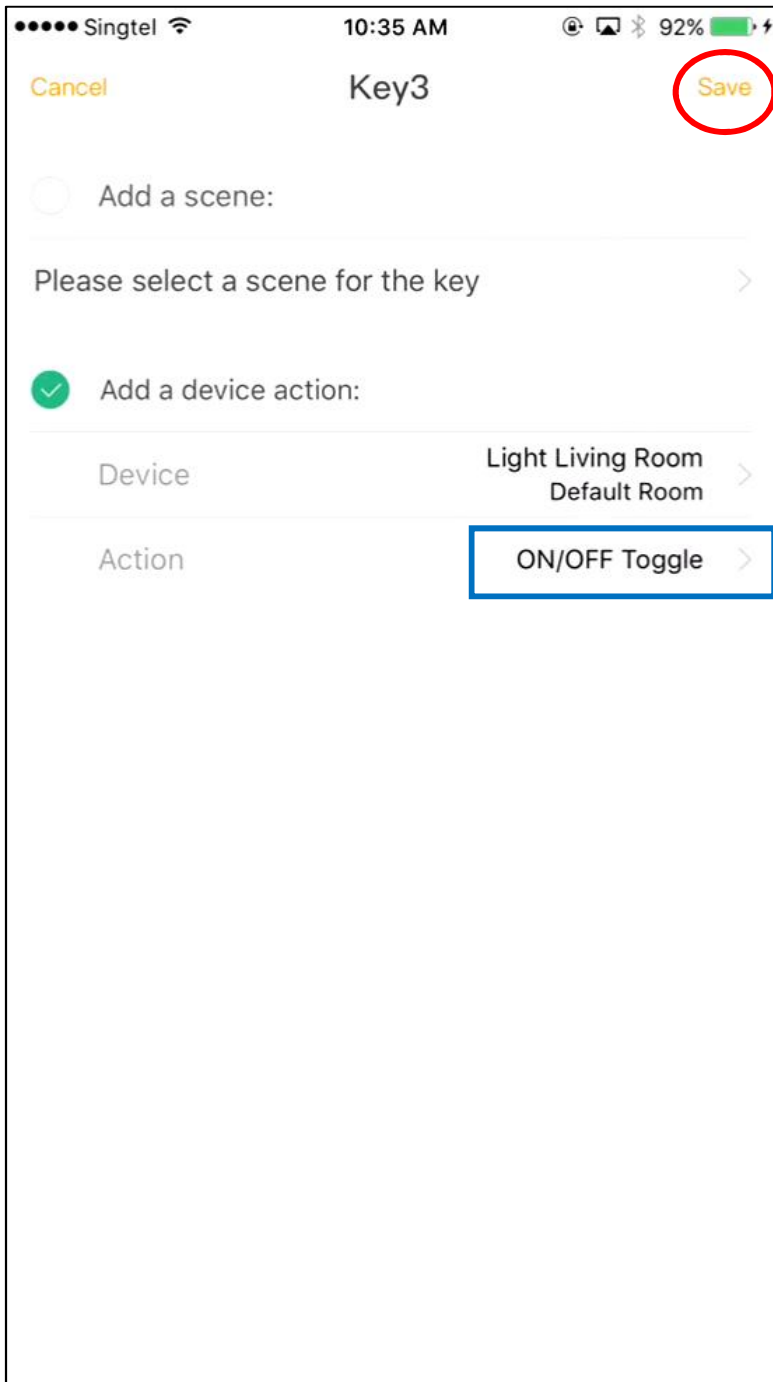

The "Action" is set, the action name is show up (Blue frame)

Then Click "Save" to save the setting.

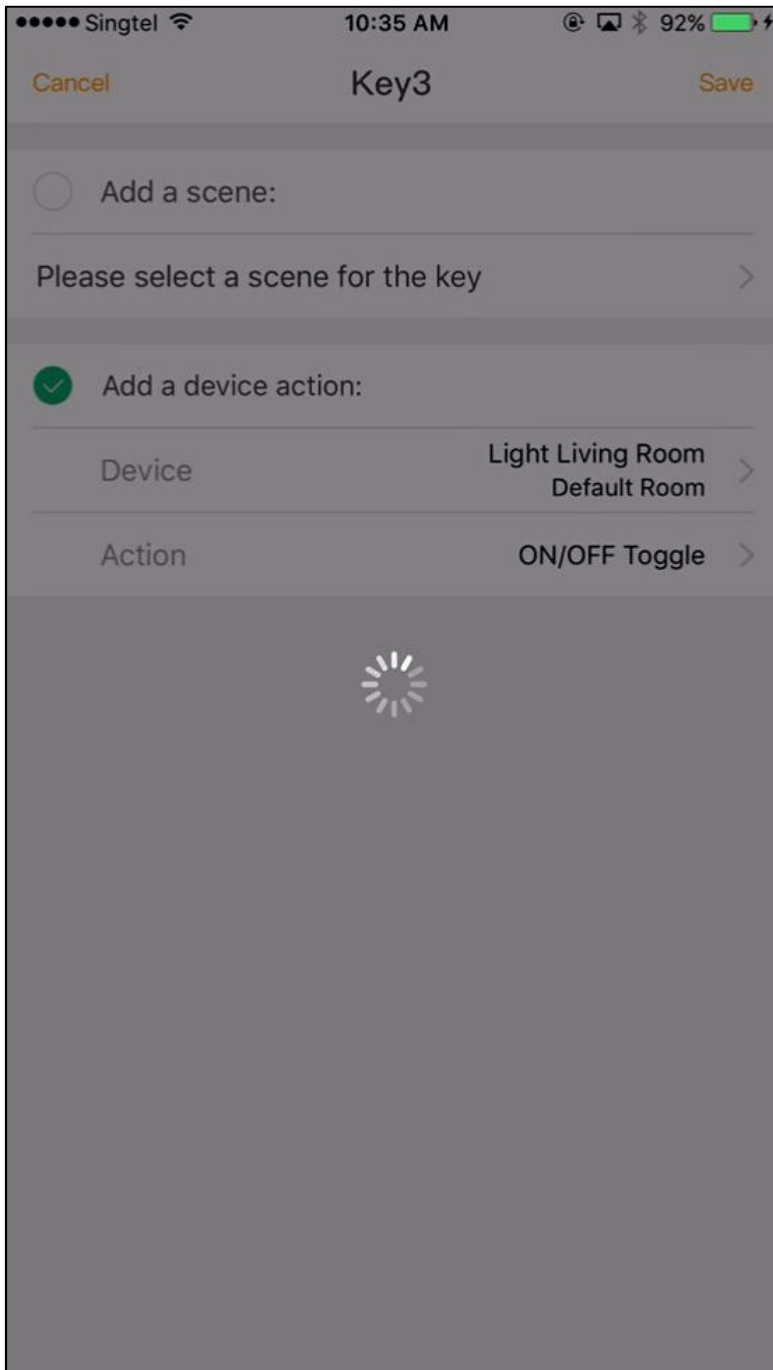

Save settings will take a few seconds

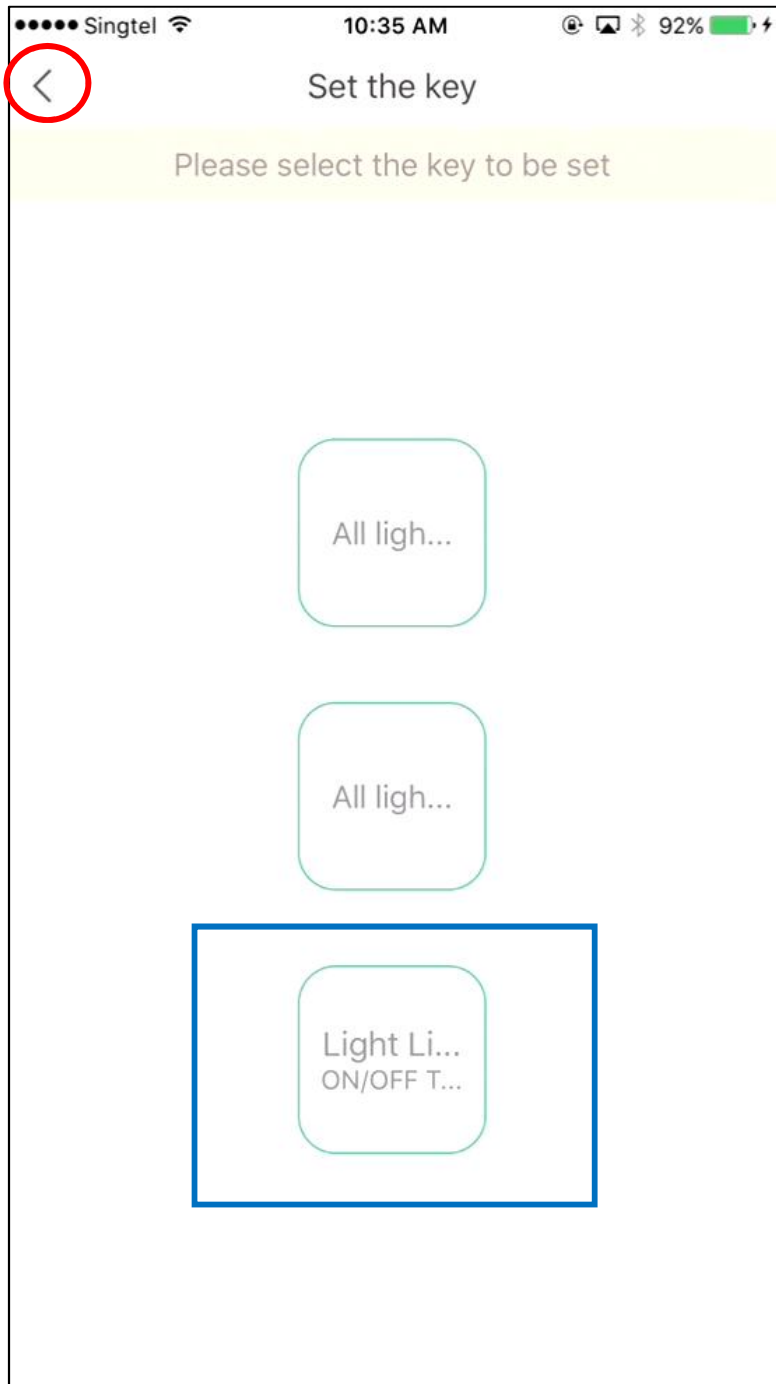

The 3rd Button is set, the name will show up (Blue frame)

Click back a few times to go back the main page.

Try it on your 3rd button of "Scene Switch"

THANK YOU